

# RG6000

## REPLACEMENT PARTS

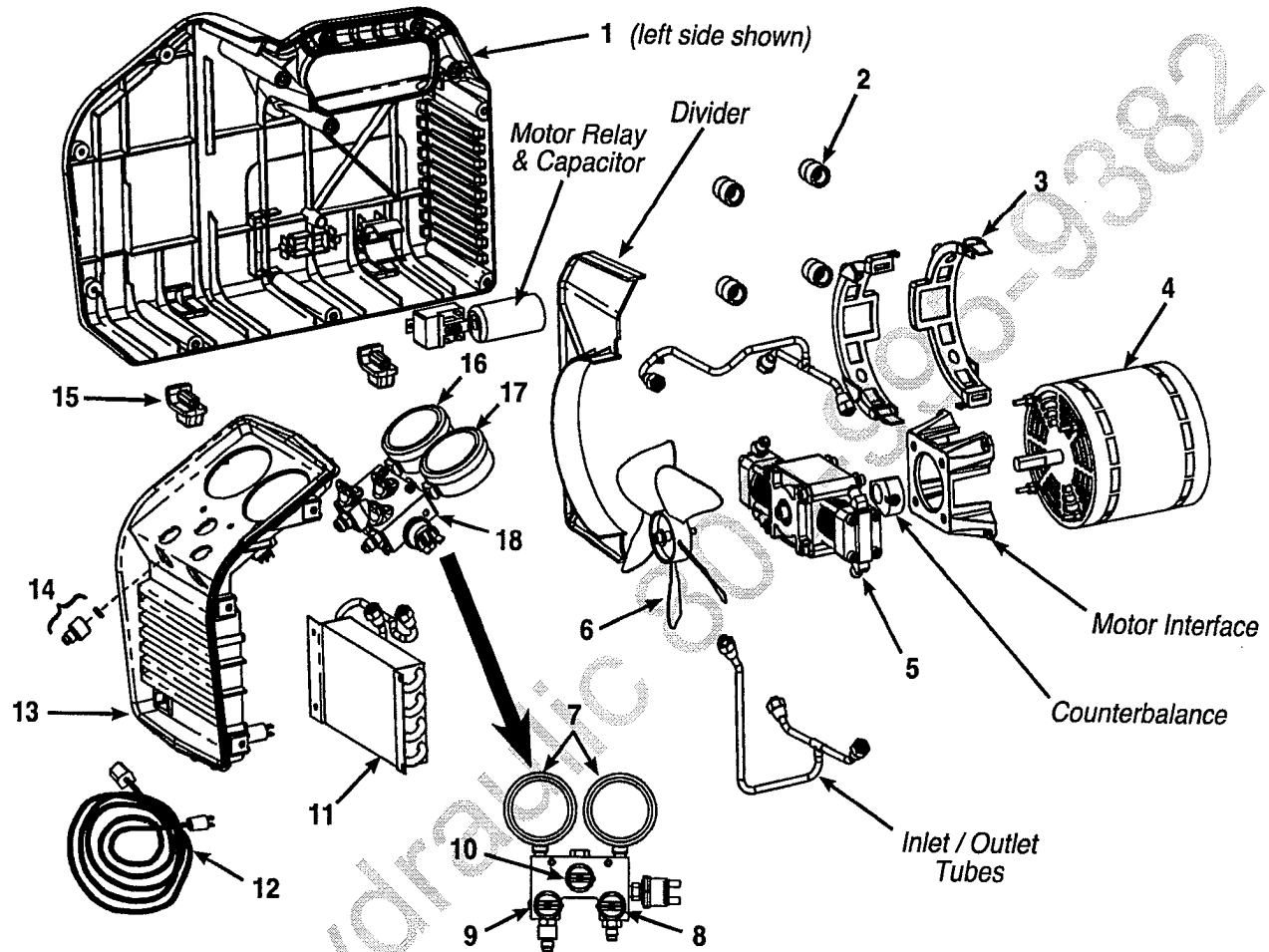

Item No.	Part No.	Qty.	Description
1	550495	1	Case Half (left)
	550496	1	Case Half (right)
2	550503	1	Grommet (1 ea.)
3	SK-6013	1	Motor Clamp Kit (4 pieces)
4	SK-6005	1	Motor Kit (includes motor, relay, capacitor, hardware)
5	SK-6017	1	Compressor Kit (includes compressor, cover, hardware)
6	Sk-6008	1	Fan Kit (includes fan, spacer mounting hardware)
7	GA1000	1	Gauge Lens (1 ea.)
8	100124	1	Manifold Knob (red)
9	100123	1	Manifold Knob (blue)
10	100122	1	Manifold Knob (black)
11	SK-6014	1	Condenser Kit (includes condenser assembly, hardware)

Item No.	Part No.	Qty.	Description
12	551628	1	Power Cord
13	SK-6012	1	Bezel Kit (includes bezel, power switch, circuit breaker, power entry module, hardware)
14	SK-6001	1	Inlet Fitting / Filter Screen Kit (includes inlet fitting, filter screen, o-ring)
15	550502	1	Foot (1 ea.)
16	SK-6003	1	Low-side Gauge Kit (includes low-side gauge, lens)
17	SK-6022	1	High-side Gauge Kit (includes high-side gauge, lens)
18	SK-6016	1	Manifold Kit (includes manifold assembly, hardware)

# REBUILD KITS AND ACCESSORIES

Part No.	Description
SK-6006	Compressor Rebuild Kit (includes piston seals, valves, springs, o-rings)
SK-6015	Piston Seal Rebuild Kit (includes piston seals, energizer o-ring, wear bands)
SK-6007	Valve Rebuild / Replacement Kit (includes inlet /oulet valves and springs, o-rings)
SK-6002	Filter / Drier Kit (includes filter / drier, 6 inch hose)

A & A Hydraulic 800-995-3382